

Please rate this document after reviewing at the bottom of this page.

REPLACEMENT

⚠ CAUTION

Put on gloves to protect your hands.

i Information

- Use a plastic panel removal tool to remove interior trim pieces without marring the surface.
- Take care not to bend or scratch the trim and panels.

1. Remove the rear seat assembly.
(Refer to Rear Seat - "Rear Seat Assembly")
2. Remove the luggage covering mat(A).

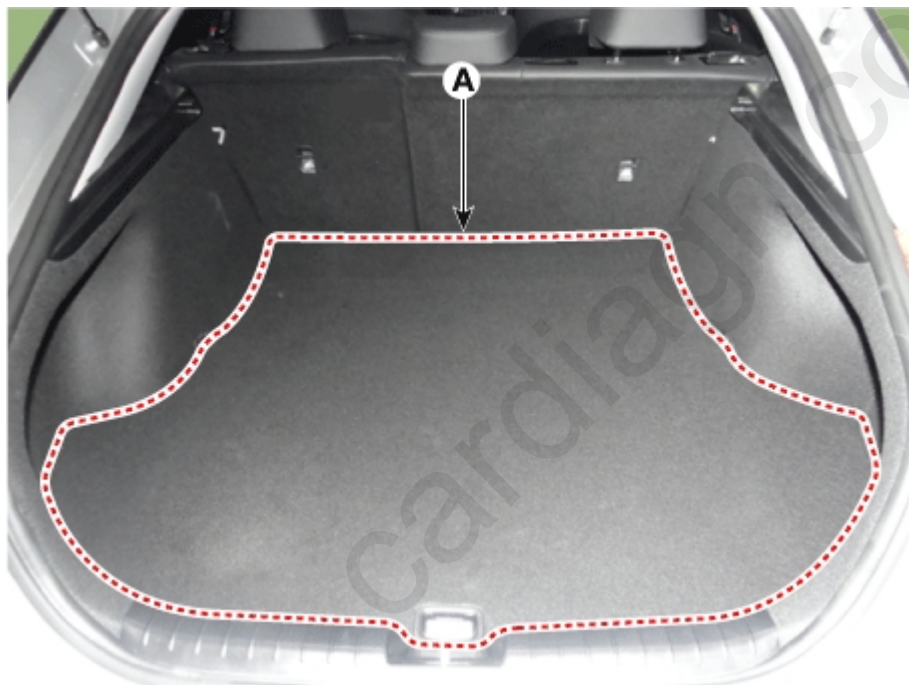

3. Remove the center tray (A).

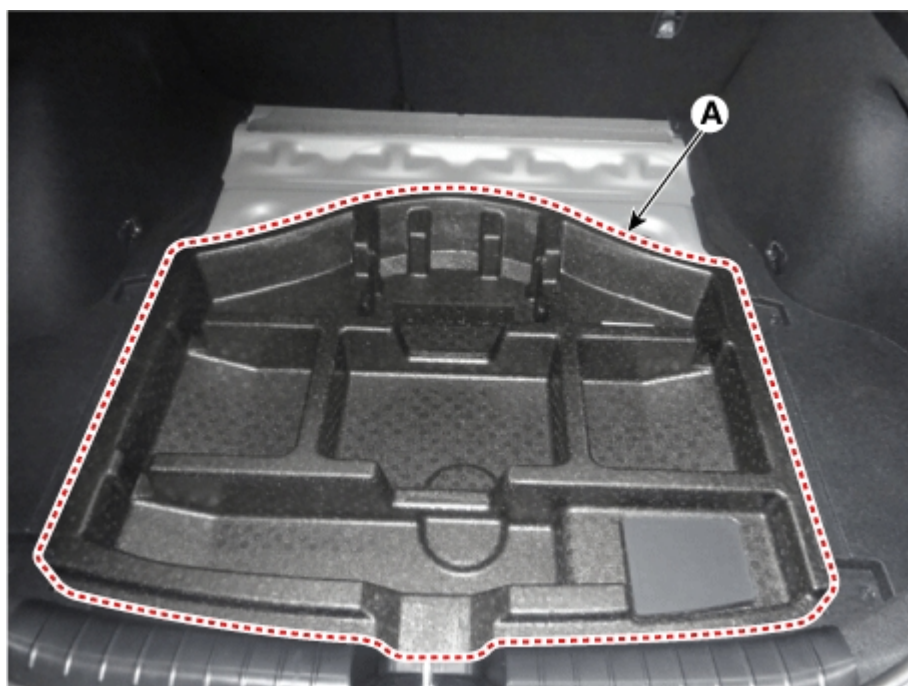

4. Remove the rear transverse trim (A).

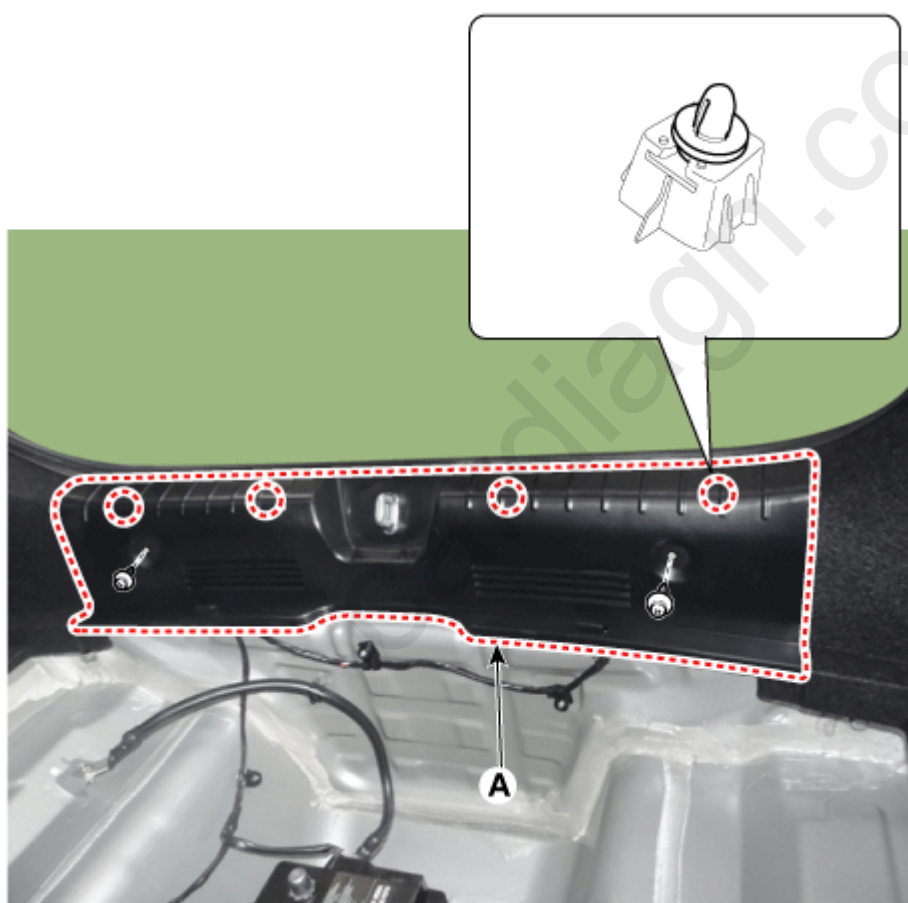

5. Separate the luggage side trim (A) after loosening the mounting screws.

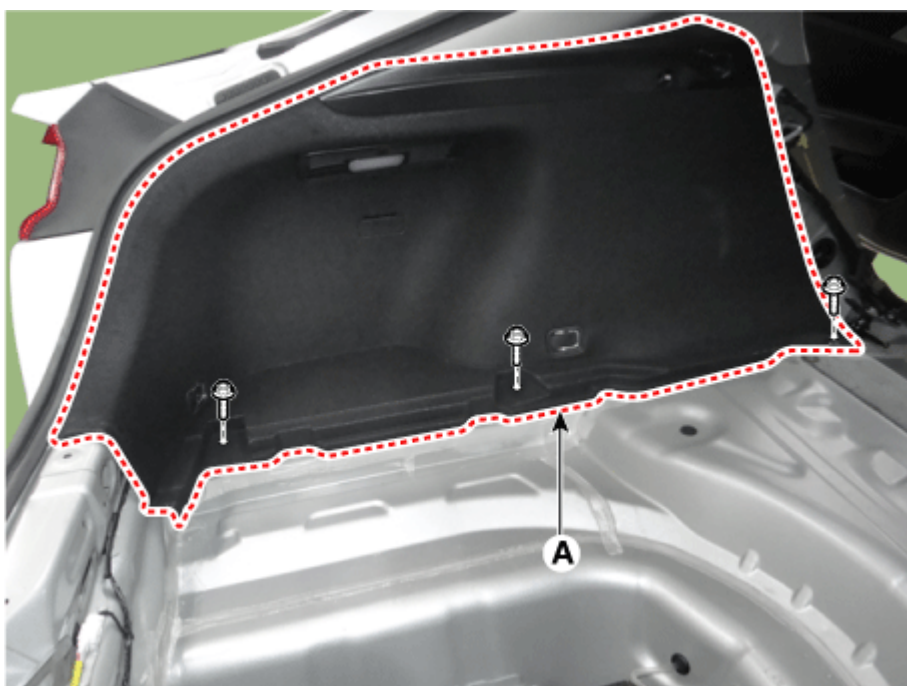

6. Remove the luggage side trim after disconnecting the luggage lamp connector (A).



7. Remove the rear pillar trim (A).

i Information

Once the trim has been removed, replace the clip (B) with a new one.

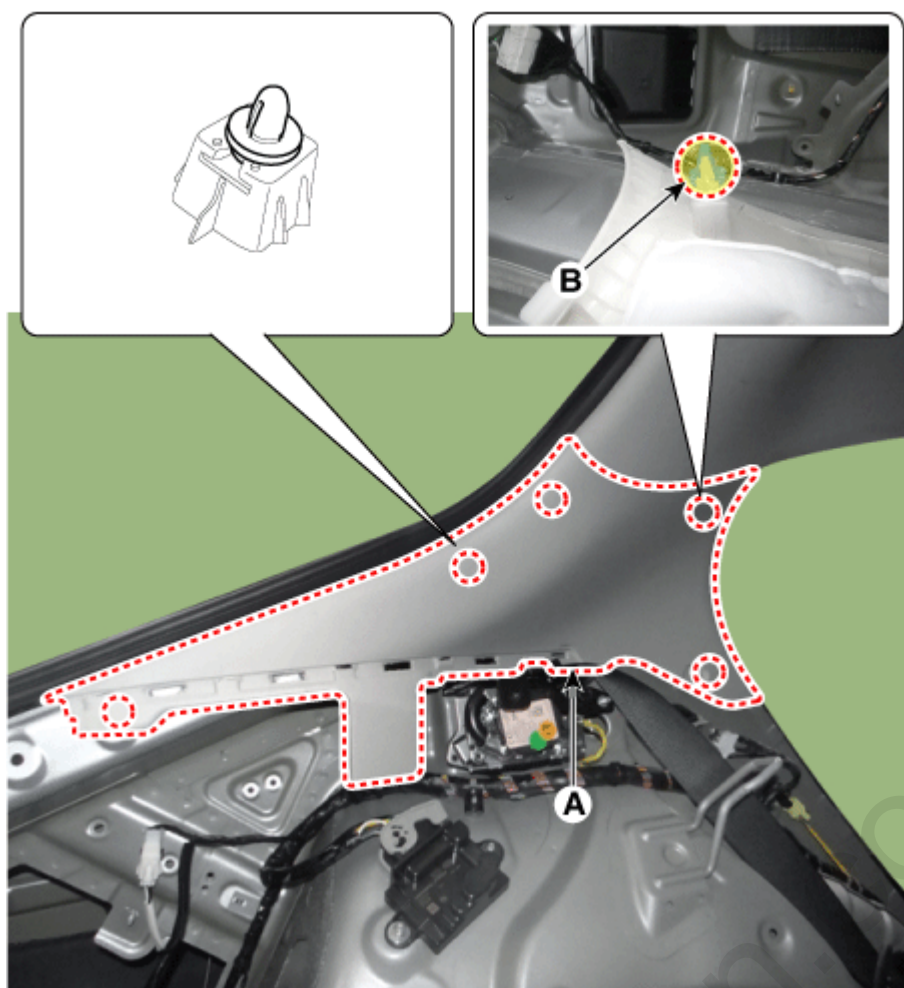

8. Install in the reverse order of removal.

i Information

- Make sure that the connector is connected properly.
- Replace any damage clips.

*** Thanks for your cooperation for the more quality. Please surely rate this document before closing.**